

3100030582 – FLEXI VACUUM 800W M-CLASS

PARTS LIST

| ITEM | QTY | DESCRIPTION | PART NUMBER |
|------|-----|--|-------------|
| 1 | 1 | COMPLETE HEAD-FLEXI VACUUM | 3100030550 |
| 2 | 1 | COVER+HEAD HANDLE F/BLACK VAC. | 4500030079 |
| 2.1 | 1 | BLACK CAP FOR VACUUM CLEANER | 3100030551 |
| 2.2 | 1 | BLACK VACUUM CLEANER HANDLE | 4600030310 |
| 3 | 1 | CABLE GLAND | 4500030138 |
| 5 | 1 | ELECTRICAL CABLE-3X1.5 SCHUKO 1.30M | 3100030552 |
| 6 | 1 | COMPLETE AUXILIARY SCHUKO SOCKET | 3100030553 |
| 7 | 1 | COVERING CAP-FLEXI VACUUM | 3100030558 |
| 8 | 1 | CABLE CLEAT | 4500030139 |
| 9 | 1 | TERMINAL CONNECTOR BLOCK | 4500033464 |
| 10 | 1 | COVER-FLEXI VACUUM | 3100030559 |
| 11 | 1 | VACUUM ANTISPLASH COMMUTATOR | 4500030063 |
| 12 | 1 | WARNING RED LIGHT-FLEXI VACUUM | 3100030560 |
| 13 | 1 | PRESSURE SENSOR-140 MILLIBARS | 3100030561 |
| 15 | 1 | FILTER HOUSING-MODULE | 7800033900 |
| 16 | 1 | VACUUM HEAD MOTOR WET STOP-WD | 7800033608 |
| 17 | 1 | DRY MOTOR SPACER | 3100030568 |
| 18 | 1 | VACUUM MOTOR 800W P.PRO55 220-240V-50/60Hz | 4500030140 |
| 19 | 1 | RUBBER RING FOR VACUUM MOTOR | 7800033098 |
| 20 | 1 | FILTER-MTP/30 65X10 L=495 | 3100030562 |
| 21 | 1 | VAC.MOTOR HOUSING+GASKET+PLATE | 4500030074 |
| 22 | 1 | PVC HOSE FOR WARNING LIGHT-D.5X3 | 3100030563 |
| 23 | 1 | GASKET H3 F/CARTRIDGE FILTER SUPP. | 3100030564 |
| 24 | 1 | O-RING-NBR SH70 | 3100030565 |
| 25 | 1 | WARNING LIGHT RUBBER HOLDER | 3100030566 |
| 26 | 1 | CARTRIDGE FILTER SUPPORT | 3100030567 |
| 29 | 1 | ONE EAR STEPLESS CLAMP D.5 | 3100030569 |

Bona[®]



Description

FLEXI VACUUM 800W M-CLASS

Part Number

3100030582

Edition

01.19 – SPARE PARTS

Page

1/2

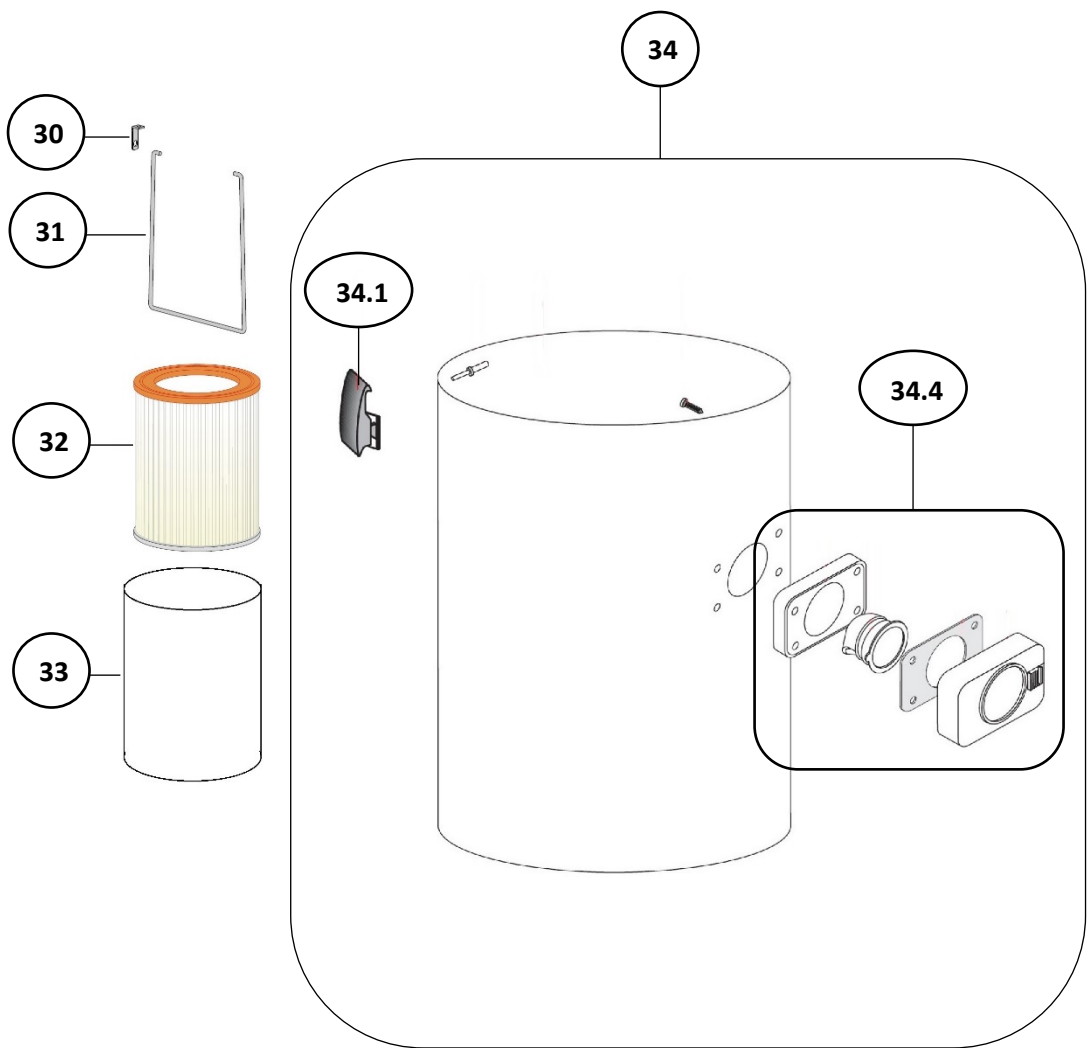

| 3100030582 – FLEXI VACUUM 800W M-CLASS | | | |
|--|-----|-------------------------------------|-------------|
| SPARE PARTS | | | |
| ITEM | QTY | DESCRIPTION | PART NUMBER |
| 30 | 2 | FILTER-LOCK BRACKET | 3100030570 |
| 31 | 1 | FILTER-LOCK ROD | 3100030571 |
| 32 | 1 | POLYESTER FILTER CARTRIDGE | 3100030572 |
| 33 | 1 | M-CLASS VACUUM PCB PRE-FILTER | 3100030584 |
| 34 | 1 | COMPLETE PLASTIC SHAFT-FLEXI VACUUM | 3100030573 |
| 34.1 | 2 | VACUUM SHAFT LOCK HOOK | 4500030067 |
| 34.4 | 1 | AIR SOCKET F/BLK.VACUUM BASKET | 4500030068 |

Bona[®]



Description
FLEXI VACUUM 800W M-CLASS

Part number
3100030582

Edition
01.19 – SPARE PARTS

Page
2/2